

# installationguide



SHARPIE HEAD KIT ASSEMBLY (Milwaukee cordless only)

from 



Upper Housing



Mandrel Screw



Grinding Wheel



Lower Housing



Mandrel



O-ring



## Step# 1



Install **O-ring** spacer to threads on motor.  
"Screw" all the way down, till contact is made to the base of motor.

## Step# 2

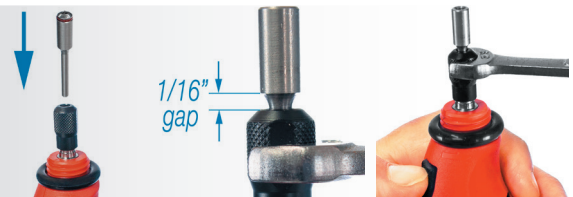

Insert **Mandrel** into collet. Leave a 1/16" (1.6mm) gap from the bottom of **Mandrel** shank. Depress lock button on motor, use 3/8"(9.5mm) open end wrench to tighten collet. **DO NOT OVER TIGHTEN**

## Step# 3



With the small allen wrench (included in kit), remove **Mandrel Screw** from the **Mandrel**. Thread on **Lower Housing** and snug down fairly tight. Align Sharpie logo with lock button on motor. Test run motor to ensure smooth operation.

## Step# 4



Remove **ONLY** the 2 side screws from **Upper Housing** using the large allen wrench (included in kit) to detach the **Upper Housing** from the **Lower Housing**



Copyright©2023, Arc-Zone.com®, Inc. All Rights Reserved

Arc-Zone.com, Inc.  
1331 Specialty Dr  
Vista CA 92081  
Tel. 760-931-1500  
sales@arc-zone.com

# installationguide



SHARPIE HEAD KIT ASSEMBLY (Milwaukee cordless only)

from 



Upper Housing



Mandrel Screw



Grinding Wheel



Lower Housing



Mandrel



O-ring



## Step# 5

Install **Grinding Wheel** while pressing the motor shaft lock button on motor.



## Step# 6

Install **Upper Housing** press down to check the grinding wheel height. It should be flush with the lower edge of the side window in the **Housing**. (To adjust the **Mandrel** height, see step #2).



## Step# 7

Thread in one side screw and leave loose.  
Thread in 2nd side screw and tighten each screw evenly .



## Step# 8

Test run motor to ensure smooth operation.



**Congrats! Your new Sharpie Tungsten Grinder is ready to go.**  
*Please be sure to use proper eye, ear and breathing protection when in use.  
Consult the Sharpie Operations Manual before operating.*



Copyright©2023, Arc-Zone.com®, Inc. All Rights Reserved

**Arc-Zone.com, Inc.**  
1331 Specialty Dr  
Vista CA 92081  
Tel. 760-931-1500  
sales@arc-zone.com